



Corridor Management Agreements primer

July 11th, 2017

What is Corridor Management?

- It's how we build our communities!
- Addresses corridors with multiple functions:



What is a Corridor Management Agreement?

a collaborative agreement among multiple communities or agencies that addresses the development, management, and operations of a roadway corridor



CMA Process

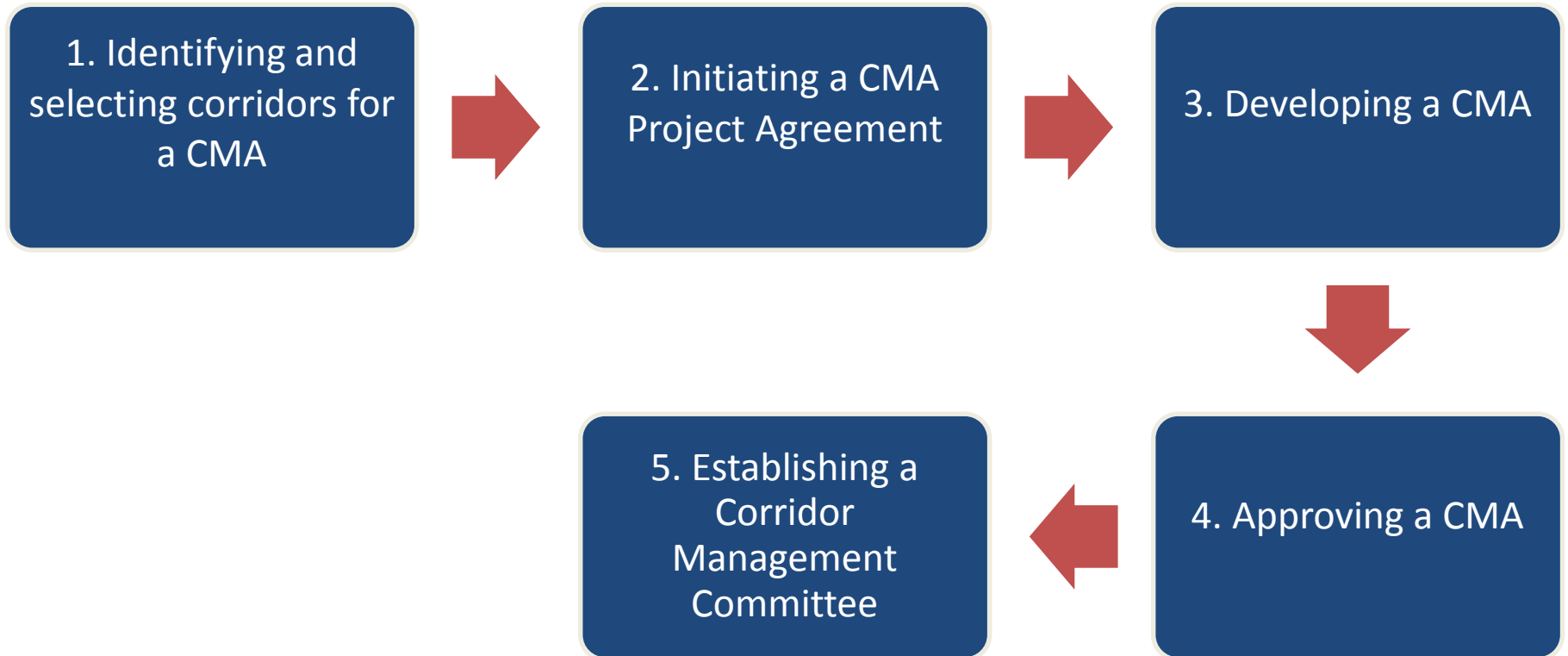

CMA Strategies

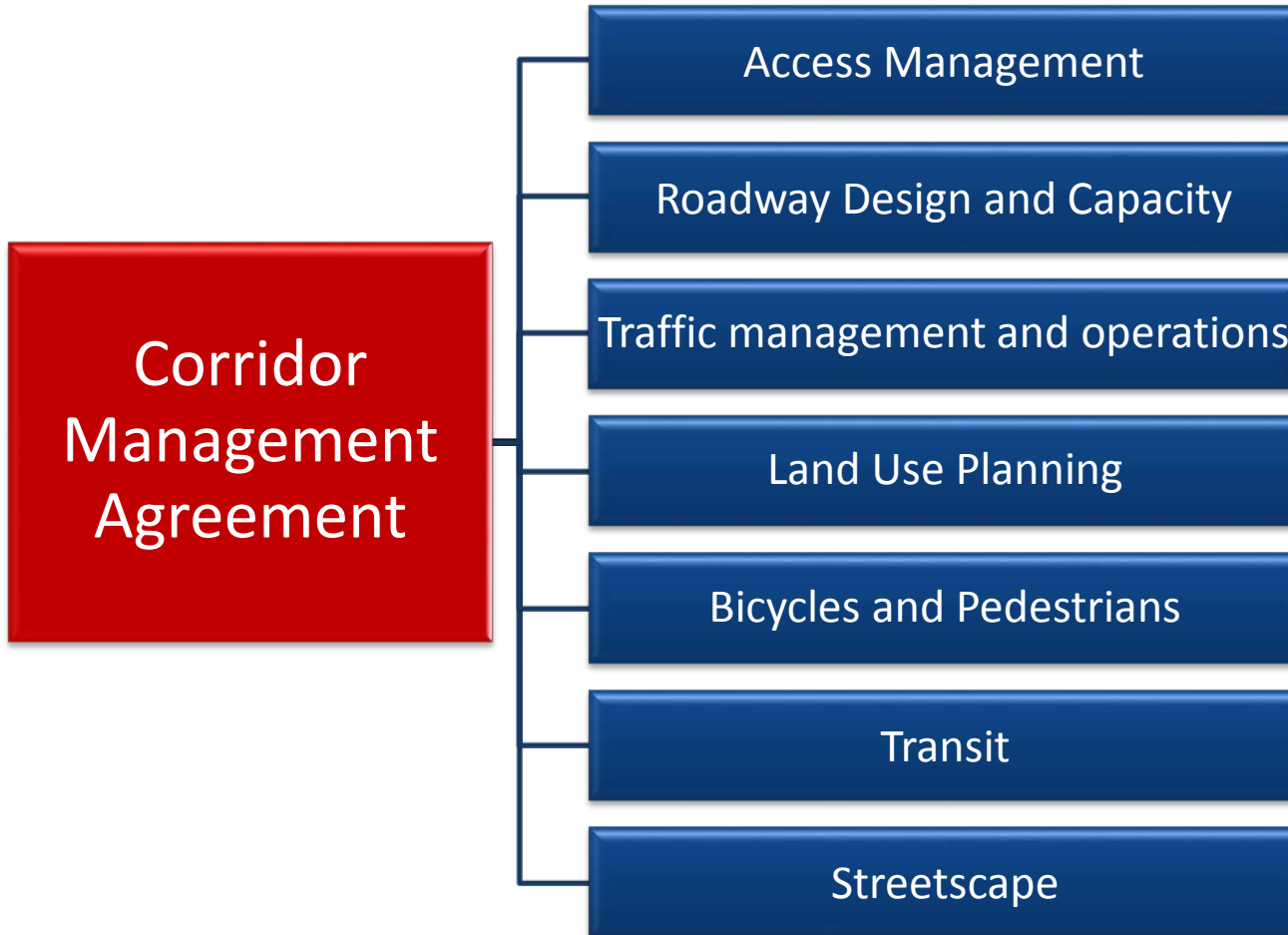

Strategy: Land Use Planning

- Land use plans
- Zoning, including design overlays
- Subdivision regulations
- Urban services plans

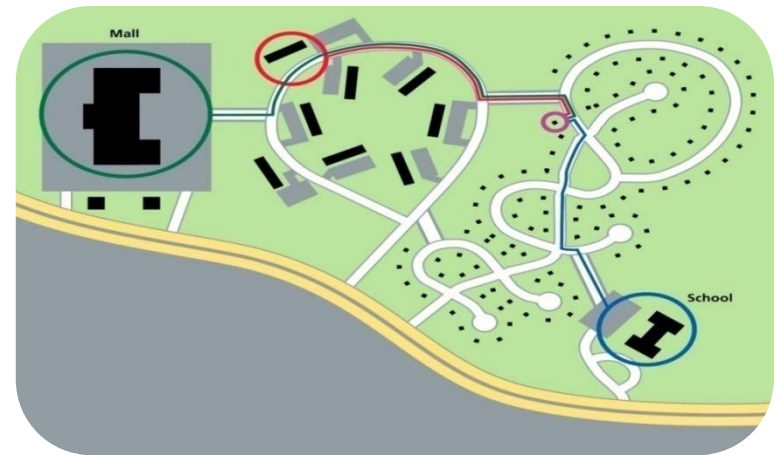
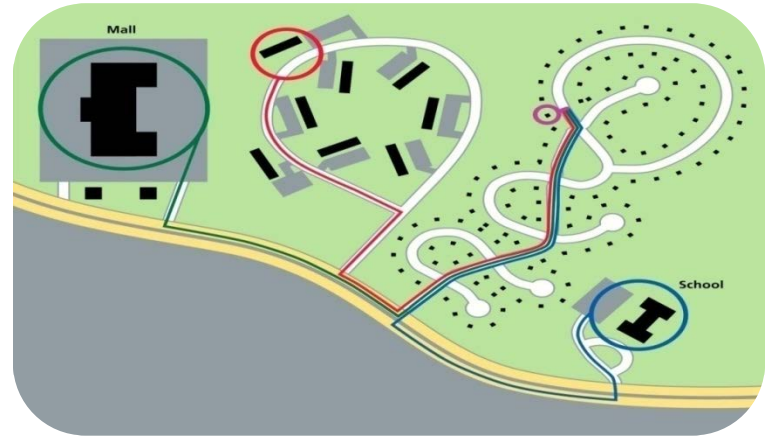

Strategy: Transportation/Land Use Objectives

- Corridor management links transportation and land use planning – four key areas:

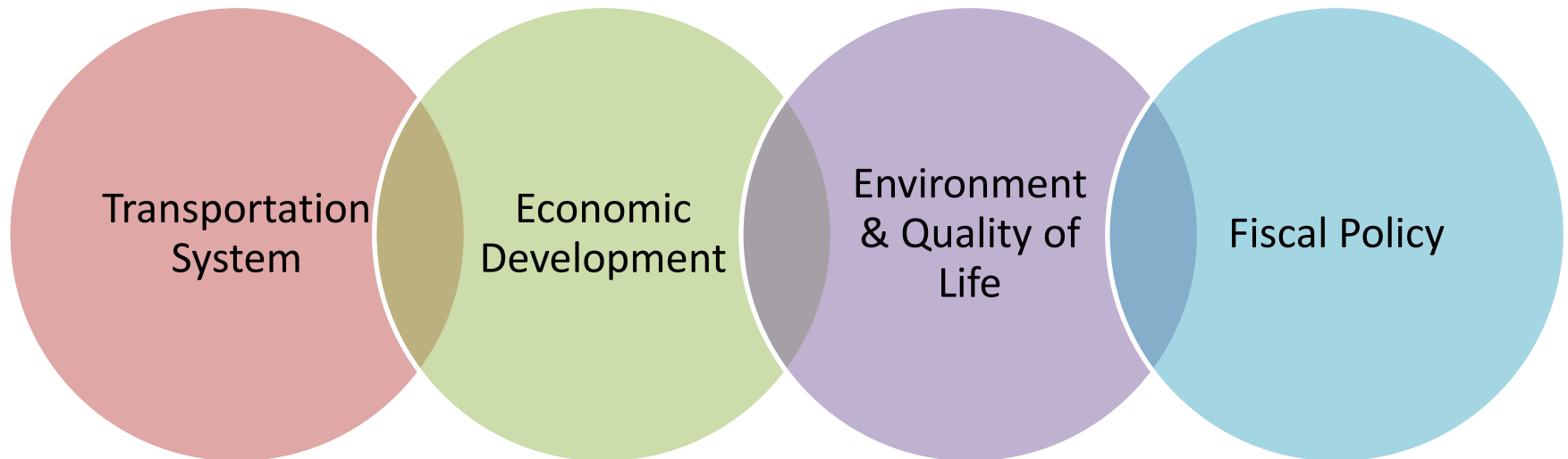

Current Progress with CMAs

- OCT has steadily worked on targeting State Routes with cross jurisdictional buy in for the Corridor Management Agreement program. The CMA program in short is collaboration on capacity preservation among the responsible jurisdictions. A CMA can be developed out of existing development plans between two jurisdictions or a regional effort to improve a number of transportation related problems. TDOT Region 1's OCT currently is working on one active CMA on SR449 through Sevierville and Pigeon Forge and another CMA on US 11E which currently in its planning phase.



SR449 Sevierville



SR449 Pigeon Forge

Veteran's Boulevard SR449 CMA

CMA covering the full length of SR 449 stretching 6.7 miles

Purpose:

The purpose of this Agreement is to provide a **framework** for the signatory agencies, organizations and governments, within the State of Tennessee Department of Transportation, the City of Sevierville and the City of Pigeon Forge to work **collaboratively in the management** of State Route 449 (SR449) between SR-35 Dolly Parton Parkway and SR-73 the Parkway and promote safe and efficient operation, enhance and sustain economic development and support environmental conservation along the corridor.

Corridor Management Strategies

Access Management;
Land Use Planning; and
Roadway Design and Capacity.

Full Committee Membership

- The MOU for the CMA outlines each member agency appoint a representative to serve on the Corridor Planning Committee
- Corridor Planning Committee's responsibility to review, approve and propose planning approaches to corridor management.
- SR449's membership includes
 - Sevierville
 - Community Development Director
 - City Alderman
 - Development Director
 - Citizen Representative
 - Pigeon Forge
 - Community Development Director
 - Citizen Representative
 - Planning Commissioner
 - Regional Land use Planner



Summary

This is a collaborative effort to benefit all parties

Builds on existing plans & programs

Establishes specific goals, strategies, & actions—change will occur over time

TDOT Long Range Planning Division

OCT Planning Supervisor, Region 1

Troy Ebbert

Troy.j.Ebbert@tn.gov

865-253-1436

OCT Planning Specialist, Region 1

Michelle Christian

Michelle.A.Christian@tn.gov

865-594-0211

OCT Planning Specialist, Region 1

Trey Joiner

Jerome.Joiner@tn.gov

865-594-2433



TDOT

Department of
Transportation

<https://www.tn.gov/tdot/section/long-range-planning-home>

<https://www.tn.gov/tdot/article/tdot-long-range-planning-division-corridor-management-agreements>