2020 TDOT CONTRACT VANS AND BUSES

Mid- South Bus Center, Inc. has been in business since 1972, which makes us the oldest bus dealership in Tennessee under continuous operation. We take great pride in providing TDOT and its related agencies with the most reputable bus and van manufacturers in the industry; StarTrans Bus, Transit-Works, and BraunAbility. Our Startrans Bus is the only manufacturer on the TDOT contract offering **93" interior width**. As you know there are already challenges faced with interior room, loading and maneuvering passengers, and space is one of your highest priorities. We are glad to continue to offer the 93" wide StarTrans Buses again as we have for many years. In addition to our location in Murfreesboro, our customer service will assist TDOT and related agencies with local service working through Ford and Dodge dealers for the chassis, and pre-approved service providers for the body, lift, and air conditioning. **We also have available 3 mobile service technicians serving the three regions of Tennessee, East, Middle, and West.**



MID-SOUTH BUS CENTER

www.thebuscenter.com



CONTACT: Jerry K. Remus
800-322-4024
jremus@thebuscenter.com

8+2

Small Medium Bus

2020 Contract: \$48,390

- Ford E350 Chassis
- 6.8L V10 Gas Engine
- 81" Interior Width
- 34" Clear Opening Entry Door
- TransAir AC 68K BTU

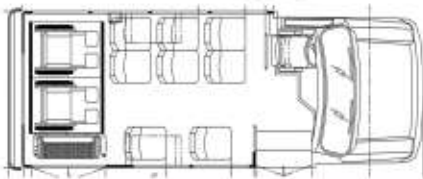

10+2

Medium Duty Bus

2020 Contract: \$49,667

- Ford E350 Chassis
- 6.8L V10 Gas Engine
- 93" Interior Width
- 34" Clear Opening Entry Door
- TransAir AC 68K BTU

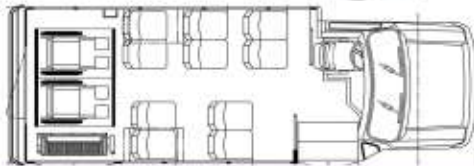

12+2

Medium Duty Bus

2020 Contract: \$49,884

- Ford E350 Chassis
- 6.8L V10 Gas Engine
- 93" Interior Width
- 34" Clear Opening Entry Door
- TransAir AC 68K BTU

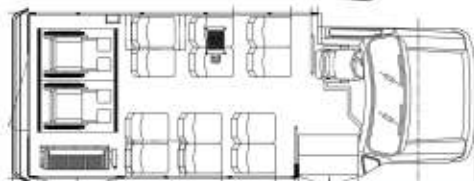

16+2

Medium Duty Bus

2020 Contract: \$52,040

- Ford E450 Chassis
- 6.8L V10 Gas Engine
- 93" Interior Width
- 34" Clear Opening Entry Door
- TransAir AC 68K BTU

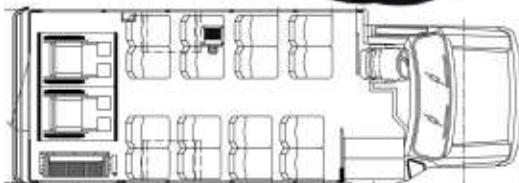

24p

Heavy Duty Bus

2020 Contract: \$50,397

- Ford E450
- 6.8L V10 Gas Engine
- 93" Interior Width
- 34" Clear Opening Entry Door
- TransAir AC 68K BTU

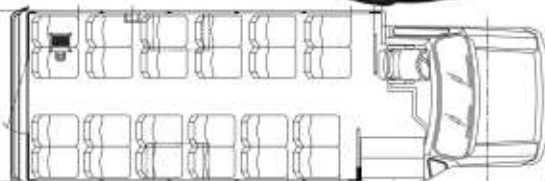

Popular Options

- Foldaway Seats
- Integrated Child Seats
- Surveillance Camera System
- MorRyde Suspension Upgrade
- Backup Camera System
- Overhead Luggage Rack
- Wheel Alignment
- Sportsworks Bicycle Rack
- Power Drivers Seat Pedestal
- 1000# Braun Wheelchair Lift
- 37" Wide Lift
- Additional Wheelchair Stations
- Altro Safety Flooring
- ADA Stop Request System
- Transign Destination Sign
- Stainless Steel Wheel Covers
- Rear Safety Bumper
- Battery Box & Tray
- AC Upgrade



6+1

Lowered Floor Mini-Van

2020 Contract: \$36,000

- Chrysler Grand Caravan
- Side Entry Ramp
- 30" Wide Ramp
- % Height: 74"
- Safety Kit

Popular Options

- Additional Restraints
- Surveillance Camera System

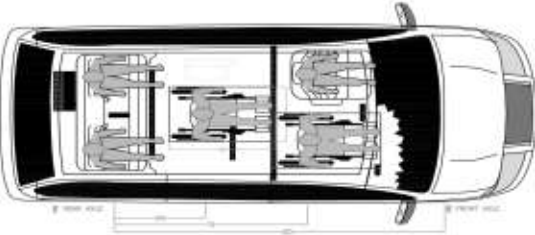

10p Center Aisle

Hi Roof Van

2020 Contract: \$36,444

- Ford Transit 150
- 10p with Center Aisle
- HD Entry Steps
- 3.5L EcoBoost V6 Engine
- Safety Kit

Popular Options

- Integrated Child Seat
- Grab Handles on Seat Backs
- Child Safety Check System
- Surveillance Camera System
- Power Heated Mirrors

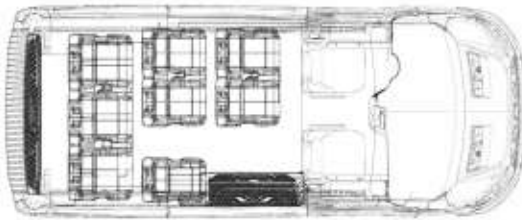

14p Center Aisle

Hi-Roof Van

2020 Contract: \$41,797

- Ford Transit 350
- 14p with Center Aisle
- HD Entry Steps
- 3.5L EcoBoost V6 Engine
- Safety Kit

Popular Options

- Integrated Child Seat
- Grab Handles on Seat Backs
- Child Safety Check System
- Surveillance Camera System
- Power Heated Mirrors
- Side Wheelchair Lift
- Rear Wheelchair Lift

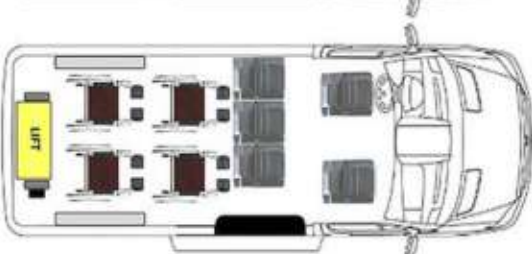
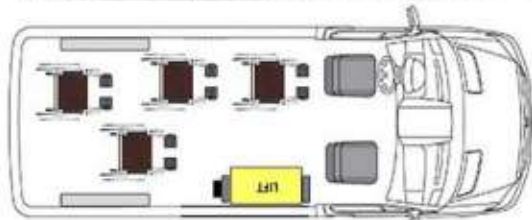
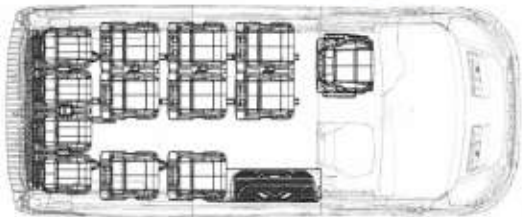

Driver Side



Braun Wheelchair Lift



Foldaway Seats



Sportsworks Bike Rack



Rear



Double Seat with Grab Handle



MorRyde RL System

